

PROJETO PARA CONSTRUÇÃO DE MORADIAS A AV. APARICIO BORGES JUNTO AO Nº 1320  
 PROPRIEDADE DE MARIA CLARA E MARIA ALBA FORTINI

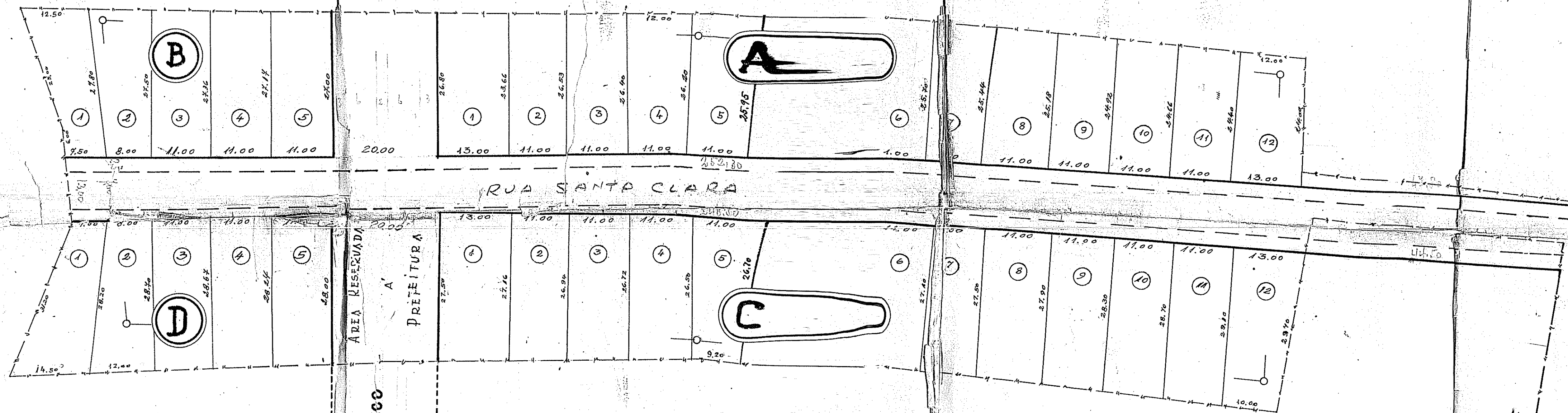

AVENIDA APARICIO BORGES

LOTEAMENTO SR. FRANCISCO SPINELLI

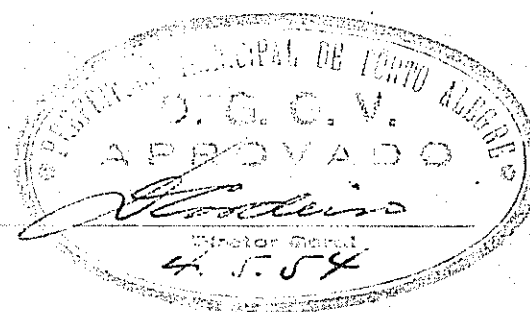
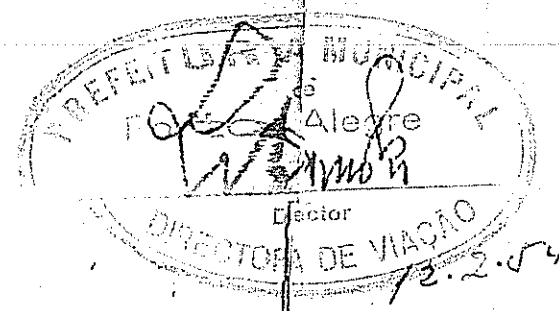
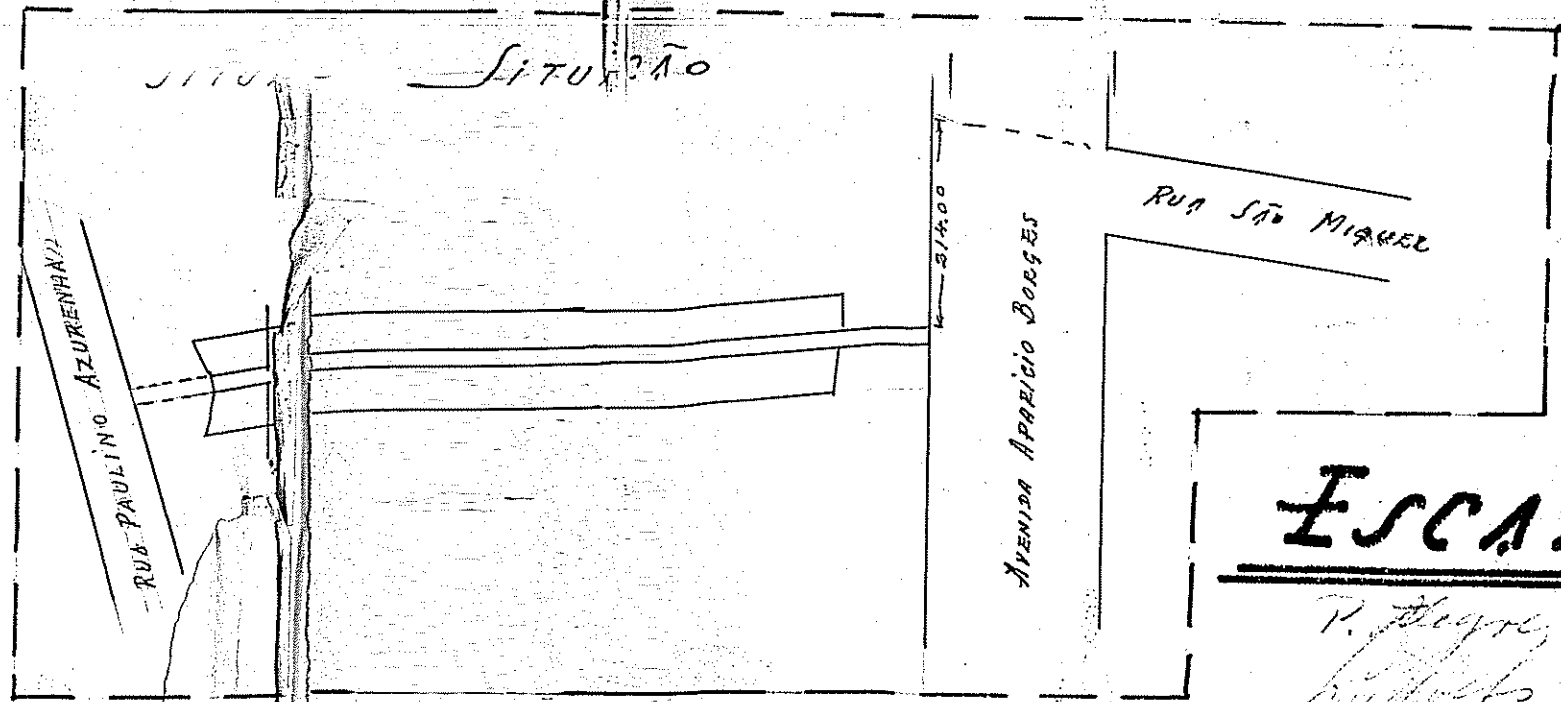

**ESCALA 1:500**

R. de Proj. 11-6-53  
 H. de Proj. B. de C.  
 C. de Proj. 11-6-53

44,60  
 110,00  
 13,00  
 12,00  
 150,60  
 200,60

PLANTA OFICIAL  
 0306.08  
 163

PASTA-169-C-32