

CGDA 32 RM  
SERVICO DO PATRIMONIO  
DEFERIDO  
PUBLICADO  
Em 27/7/67

ESCALA 1:500

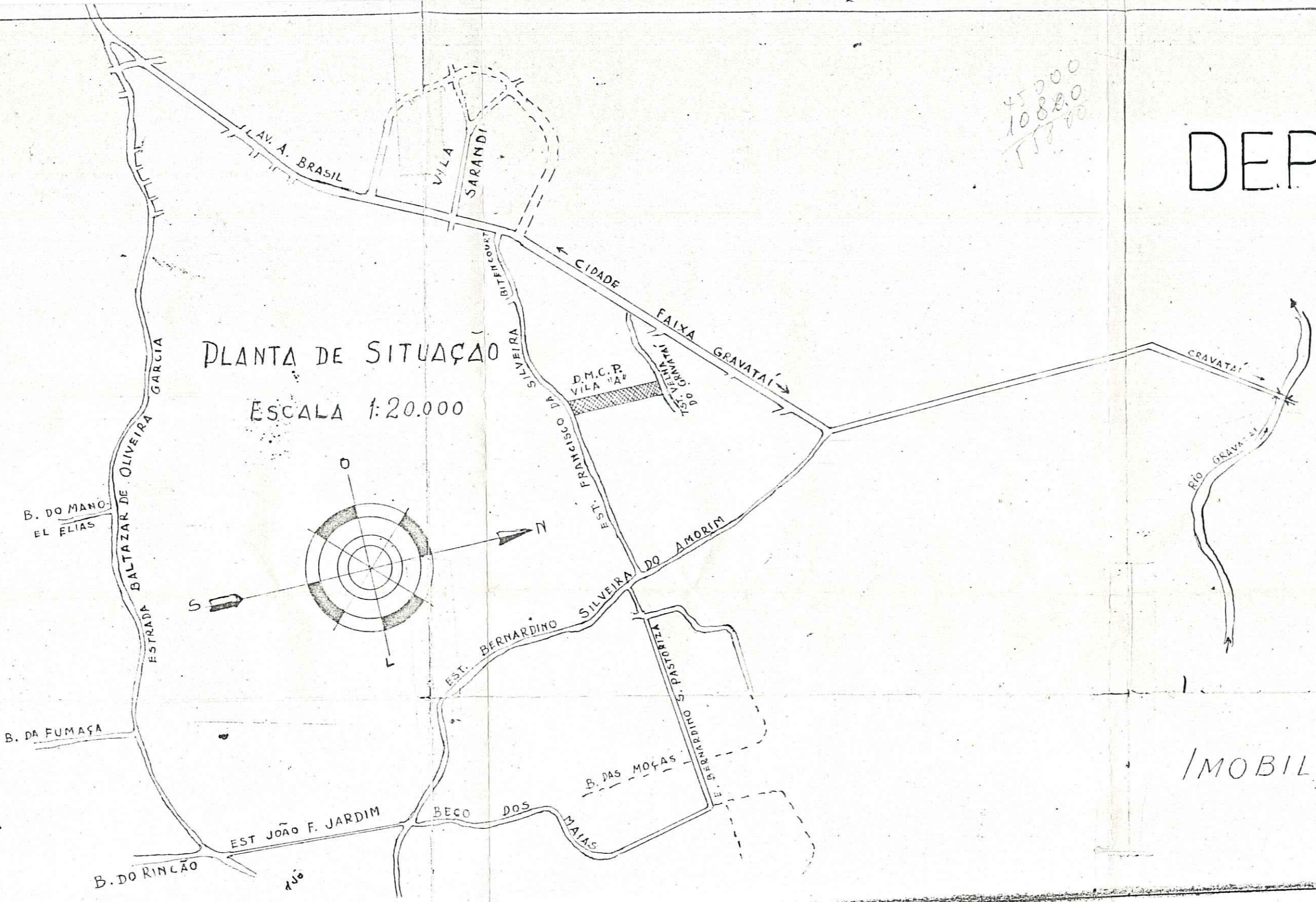
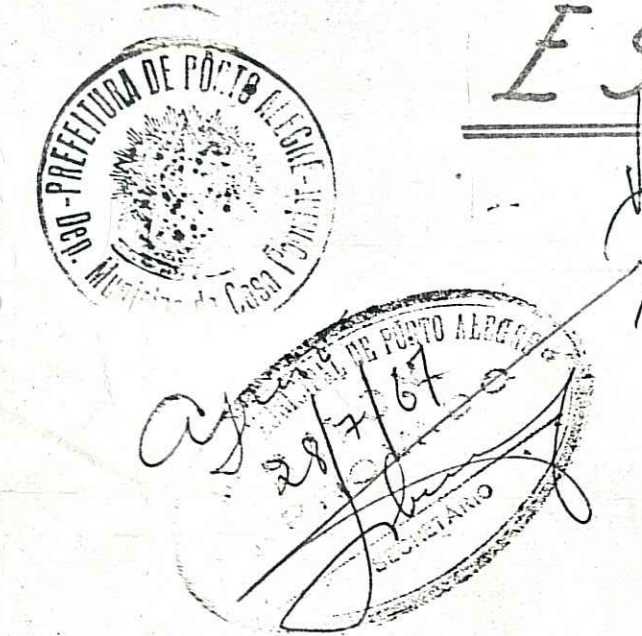

# DEPARTAMENTO MUNICIPAL DE HABITAÇÃO EX D. M. C. P.

PROJETO DE LOTEAMENTO  
DA VILA "A" - SÃO BORJA

SITUADA NO SARANDI  
9º DISTRITO DE PORTO ALEGRE

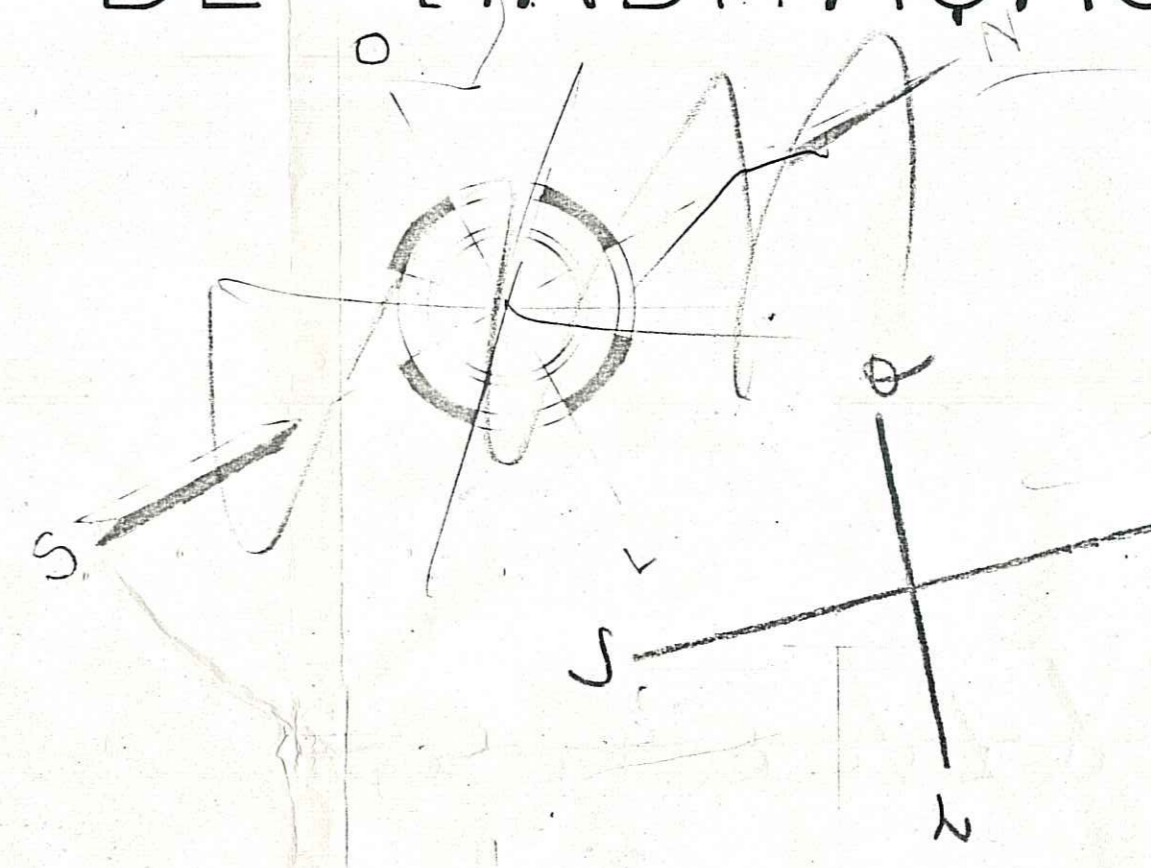

IMOBILIARIA LEÃO LTDA

GABARITO DAS RUAS ESCALA 1:100

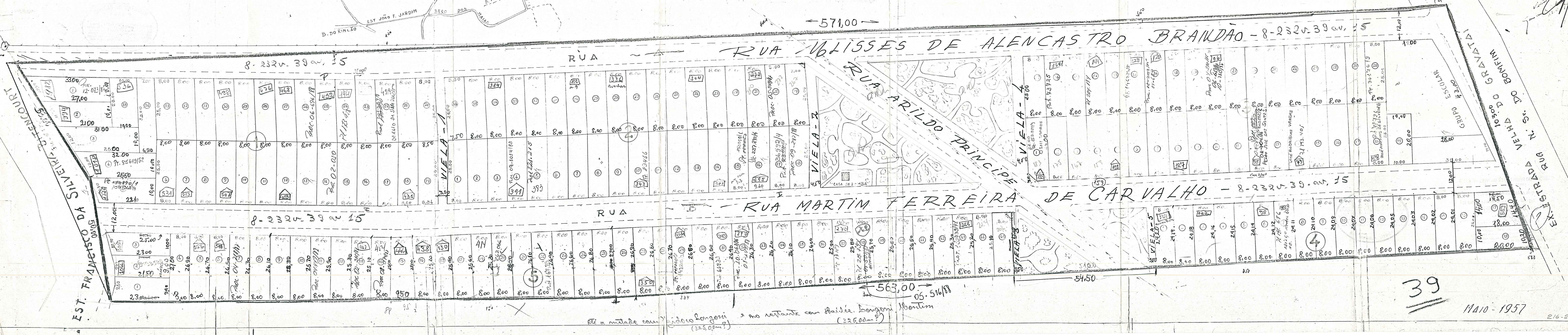

39

MAIO - 1957

no restante com Anilza Bengoni Montini (325,00m²)