

Proc. 17810/61
 APROVADO EM 13-12-63 S/T. COMPR.
 16.486/66 - Vistos total - 14.10.66

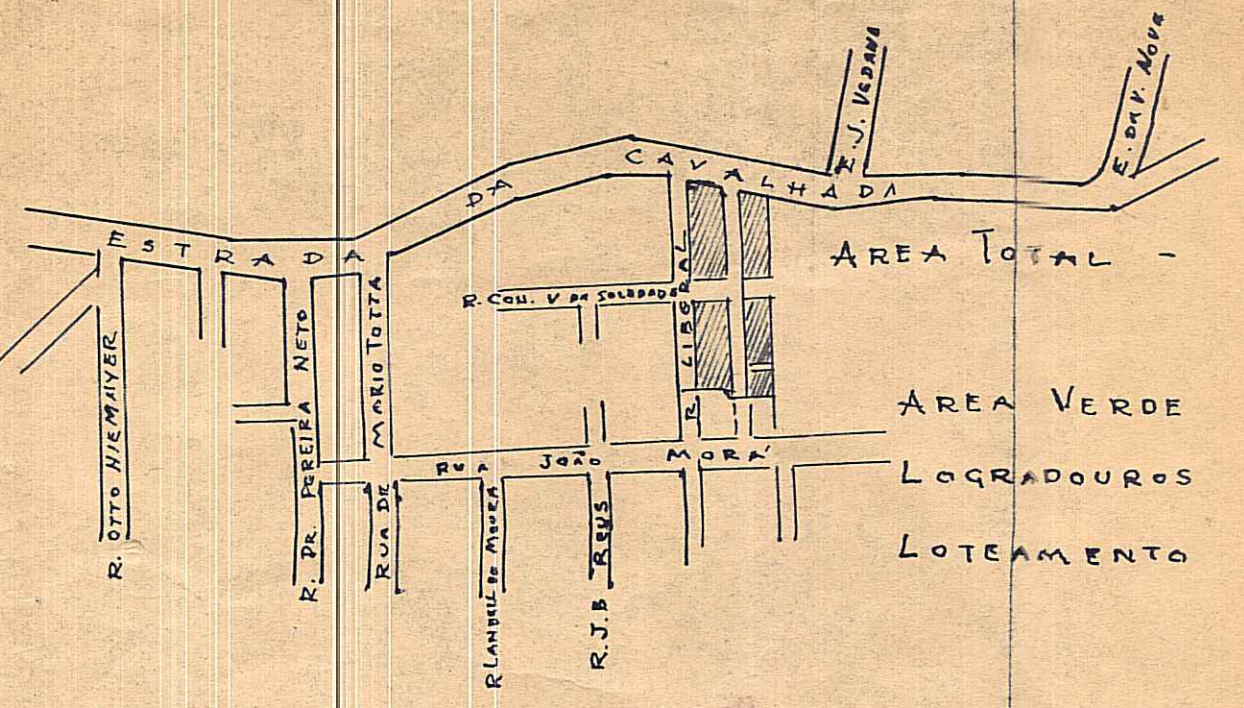

AREA TOTAL - 31.892,82 m²
 AREA VERDE 138,60 m²
 LOGRADOUROS 9.158,00 m²
 LOTEAMENTO 22.734,82 m²

QUADRA A	- 8.355,96 m ²
B	- 5.426,96 m ²
C	- 4.876,95 m ²
D	- 2.874,95 m ²
E	- 1.200,00 m ²
TOTAL	22.734,82 m ²

ESCALA 1:2.000

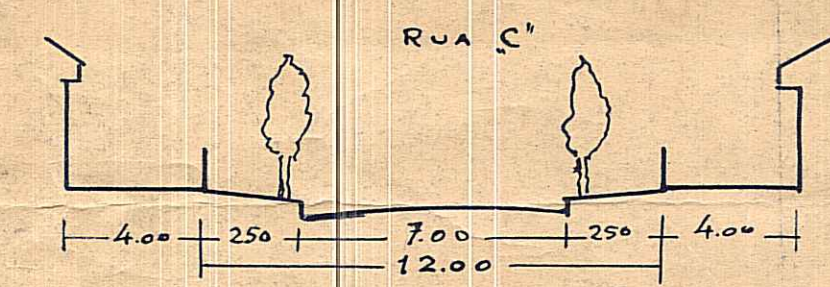

EST. VILAMARIA - 24,00 x 15,00 = 360,00 m²
 RUA LIBERAL - 29,00 x 13,00 = 377,00 m²
 RUA P. V. DA SAUDE - 105,00 x 13,00 = 1.365,00 m²
 RUA 'C' - 49 x 12,00 = 588,00 m²
 TOTAL - 9.158,00 m²

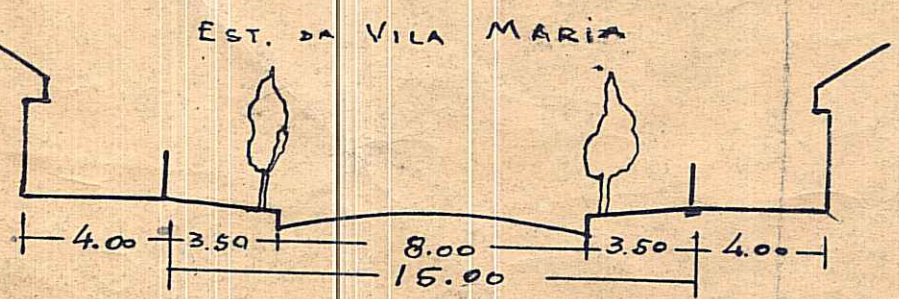
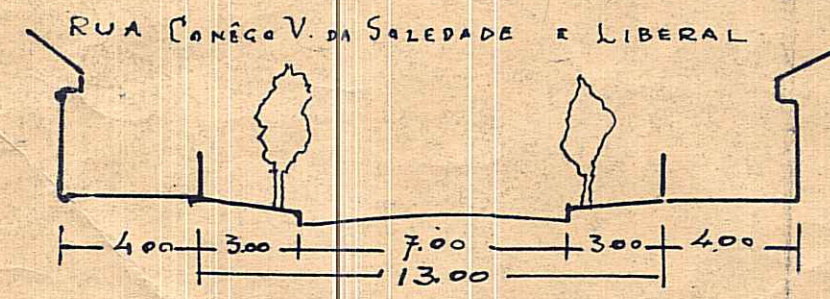

PLANILHA			
ESTAC.	ESTAC.	ANGULOS INTERNOS	DISTANCIAS
0	8	1 70° 02' 00"	253,70
1	0	2 96° 09' 00"	48,72
2	1	3 275° 05' 00"	26,85
3	2	4 72° 58' 00"	93,50
4	3	5 88° 12' 00"	70,20
5	4	6 182° 08' 00"	72,83
6	5	7 126° 03' 00"	8,45
7	6	8 242° 57' 00"	88,50
8	7	0 166° 26' 00"	130,50

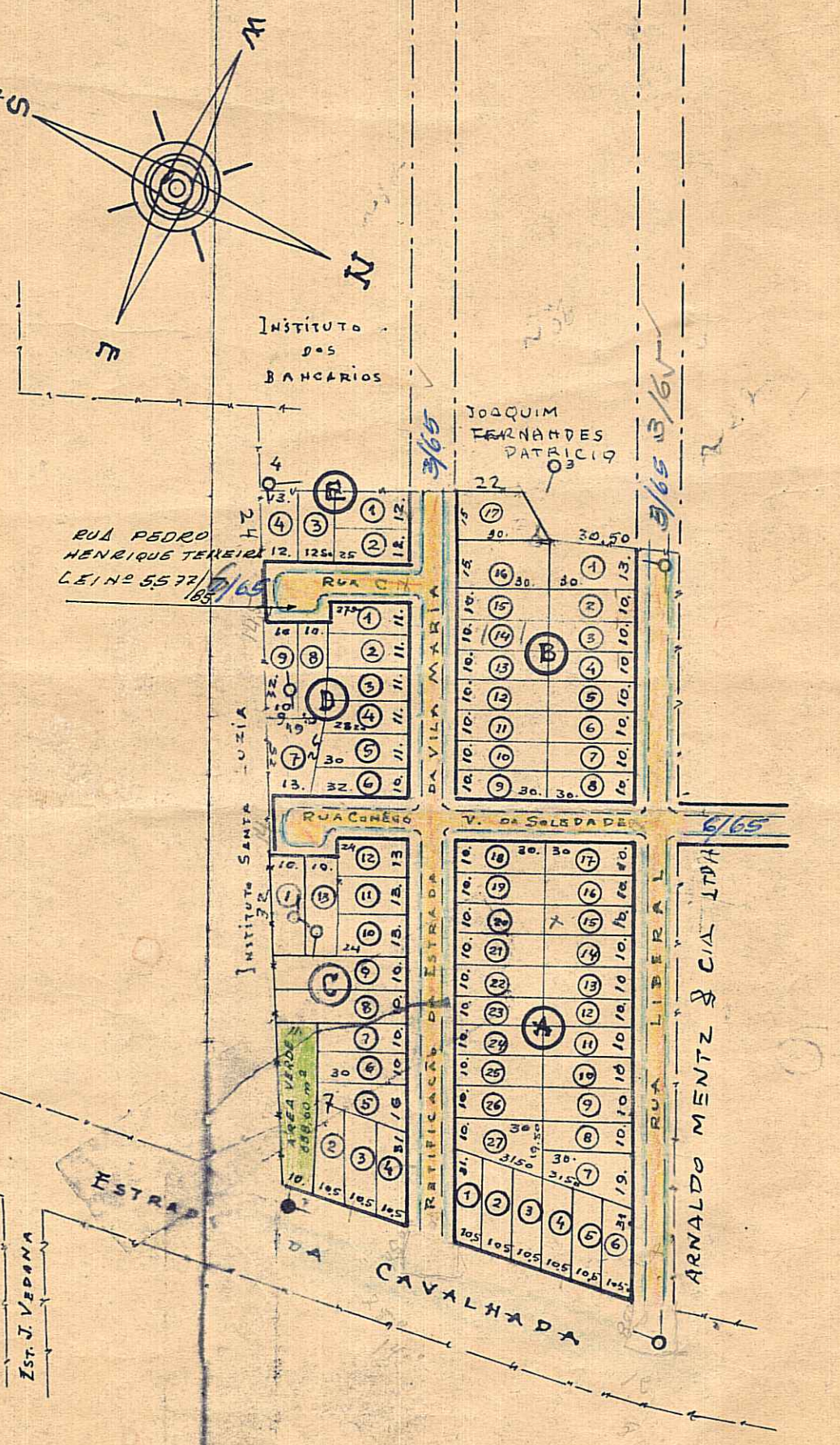

JARDIM SANTA LUZIA

PREFEITURA MUNICIPAL DE PORTO ALEGRE
 S. M. O. V.
 DIV. VIAÇÃO

CAVALHADA



6.º DISTRITO

PÔRTO ALEGRE

Ruy de Viveiros Leiria

RESPONSÁVEL TÉCNICO:

PLANO OFICIAL
 03.03.1955
 PASTA 293

RUY DE VIVEIROS LEIRIA
 Urbanista
 PRAÇA OTTONIO LOYOLA, 75
 P. ALEGRE

PROPRIETÁRIO:

TERRITORIAL CRUZEIRO S/A

P. P. Laurindo