

ESCALA 1:500

# DIVISÃO EM LOTES DA CHACARA DO EUCALIPTO

## PROPRIEDADE DO SR. ANGELO M. LA PORTA.

*Arruamentos e loteamentos  
removidos de presente planta  
estão devidamente aprovados  
pela Prefeitura Municipal  
de Alegre 5-4-38  
Alvaro L. S. de Sá  
Diretor de Obras.*

CONSTRUTOR: *J. P. de Souza*  
*Georg de Castro*

### RESUMO

AREA DO TERRENO TOTAL - 31257,468m<sup>2</sup>  
 AREA DAS RUAS - 7824,180m<sup>2</sup>  
 AREA TOTAL DOS LOTES - 23433,288m<sup>2</sup>

### AREA DOS LOTES

1	242,843	33	286,465	65	257,565
2	193,113	34	253,220	66	257,950
3	231,990	35	253,715	67	288,335
4	230,850	36	254,210	68	259,042
5	233,855	37	254,705	69	240,570
6	235,565	38	255,200	70	303,142
7	236,280	39	255,695	71	247,230
8	235,400	40	256,190	72	220,550
9	234,575	41	256,685	73	220,550
10	233,750	42	257,180	74	220,825
11	232,875	43	257,675	75	221,100
12	232,045	44	258,170	76	221,100
13	231,220	45	258,665	77	221,100
14	230,395	46	259,160	78	221,375
15	229,570	47	301,860	79	197,470
16	228,690	48	250,850	80	201,600
17	228,415	49	259,800	81	249,799
18	227,040	50	247,775	82	232,290
19	226,160	51	248,375	83	220,000
20	225,335	52	248,875	84	219,945
21	224,510	53	249,425	85	219,835
22	203,350	54	249,975	86	219,725
23	202,650	55	250,580	87	219,615
24	202,150	56	251,240	88	219,505
25	202,600	57	251,900	89	219,395
26	241,285	58	252,560	90	219,285
27	264,377	59	253,165	91	219,175
28	232,502	60	253,770	92	219,065
29	232,155	61	465,822	93	218,955
30	231,809	62	398,919	94	218,845
31	231,512	63	256,890	95	224,614
32	399,921	64	257,235	96	253,175

### SITUAÇÃO GERAL

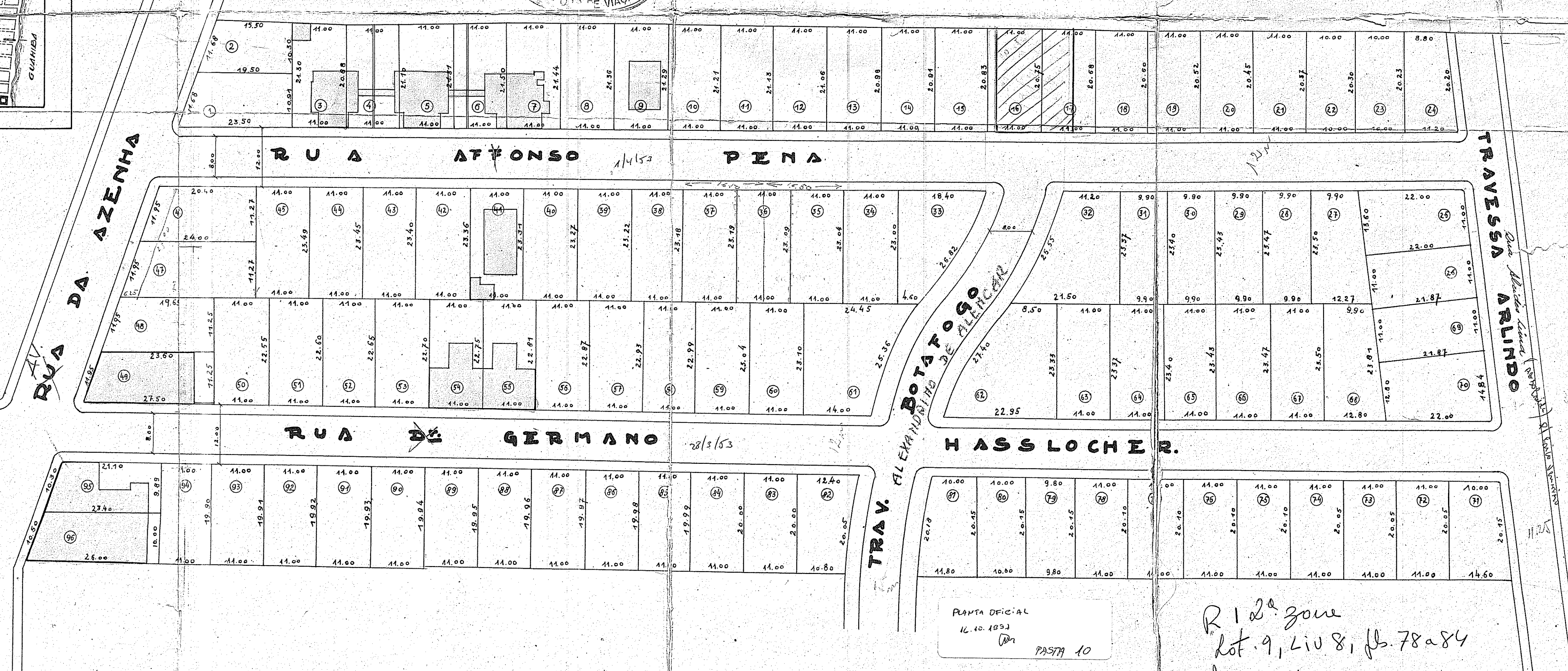
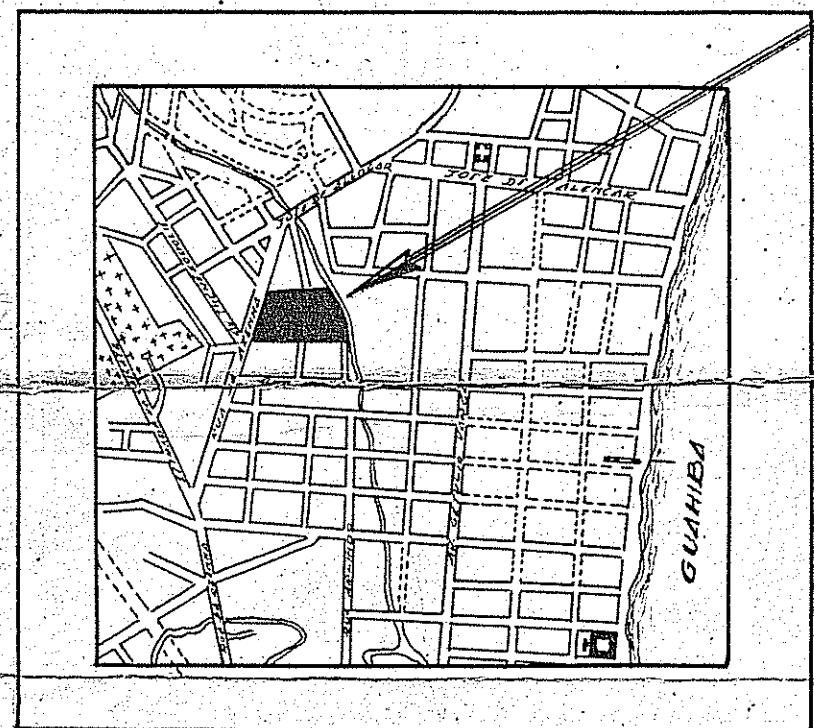

PUNTA OFICIAL  
 16.10.1953  
 10377 10

R 12ª zone  
 lot. 9, Liv 8, fs. 78 a 84  
 Aprov. e reg.